



Producto distribuido por

SDM
Oil & Gas

 (+51) 999 012777  ventas@sdm.pe

www.sdm.pe | Av. Galvez Barrenechea 274. San Isidro

ON VEHICLE

Check Valves



CVS Series check valves provide an important feature for CNG powered vehicles. When installed immediately after the fueling receptacle it functions as a redundant sealing device in the fill line, only allowing flow in one direction, from the dispenser to the vehicle.

Features:

- Three piece valve resists seal washout
- Soft seat with low crack pressure improves system efficiency
- Inline check valve provides unidirectional flow - natural gas will only flow from dispenser to vehicle
- Special Nitrile seals for CNG

Materials of Construction

Material	Stainless with Nitrile Seals
-----------------	------------------------------

Specifications

Service Pressure	3600 psi
Temperature	-40°F to +250°F [-40°C to +121°C]

CVS Check Valve with Male Face Seal and Male O-ring Boss

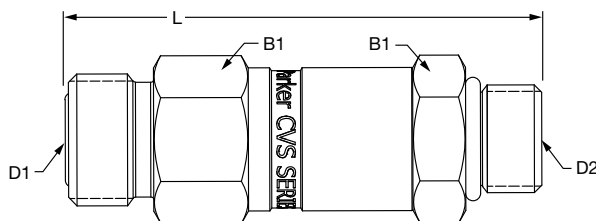

Part Number	L - Length	B1 - Hex	D1 - Port End (inlet)	D2 - Port End (outlet)	Crack Pressure
CVS-363-6MSMO-10	2.45" (62.2 mm)	0.75" (19.0 mm)	11/16-16 UN Male Face Seal	9/16-18 UNF Male ORB	10 psid

CVS Check Valve with Male Face Seal and Female Face Seal

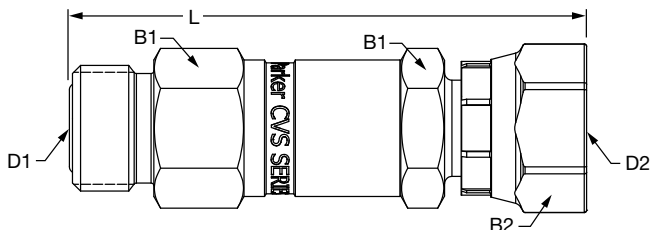

Part Number	L - Length	B1 - Hex	B2 - Hex	D1 - Port End (inlet)	D2 - Port End (outlet)	Crack Pressure
CVS-363-6MSFS-10	2.79" (70.8 mm)	0.75" (19.0 mm)	0.813" (20.6 mm)	11/16-16 UN Male Face Seal	11/16-16 UN Female Face Seal	10 psid

Contact the Quick Coupling Division for other port configurations.